

TECHNICAL BULLETIN

For the Attention of : Installers, Trade Customers, Training Dept.

Date : 05/03/07.

Product : Midilift SL.

Subject : Midilift SL fixing details and the use of a spreader plate.

Status : Information only.

Pages : 2

Originator : Stannah Lifts Ltd, Anton Mill, Andover, Hants SP10 2NX 01264 339090

Detail

The Midilift SL should be secured (amongst other positions) at threshold level in position C as indicated on data sheet AVL 622 (T). To facilitate this, a guide fixing bracket is supplied. However if this bracket cannot be used then the spreader plate, part number 6101217, should be used to secure the lift at threshold level as detailed in figures 1a and 1b.

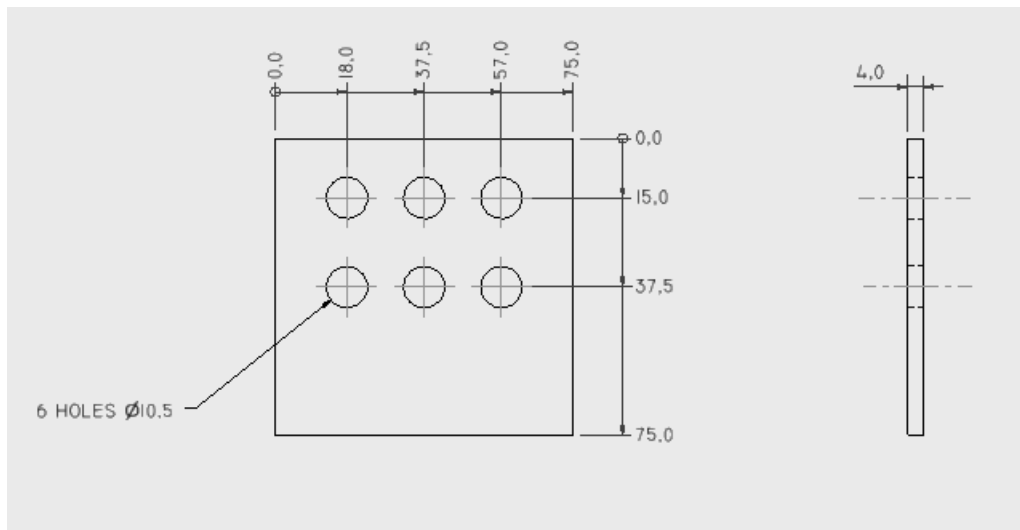

Spreader plate, extract from 6101217.

Summary

The spreader plate should be placed inside the corner upright (fig. 1) and the lift then secured through the spreader plate, corner upright and into the threshold.

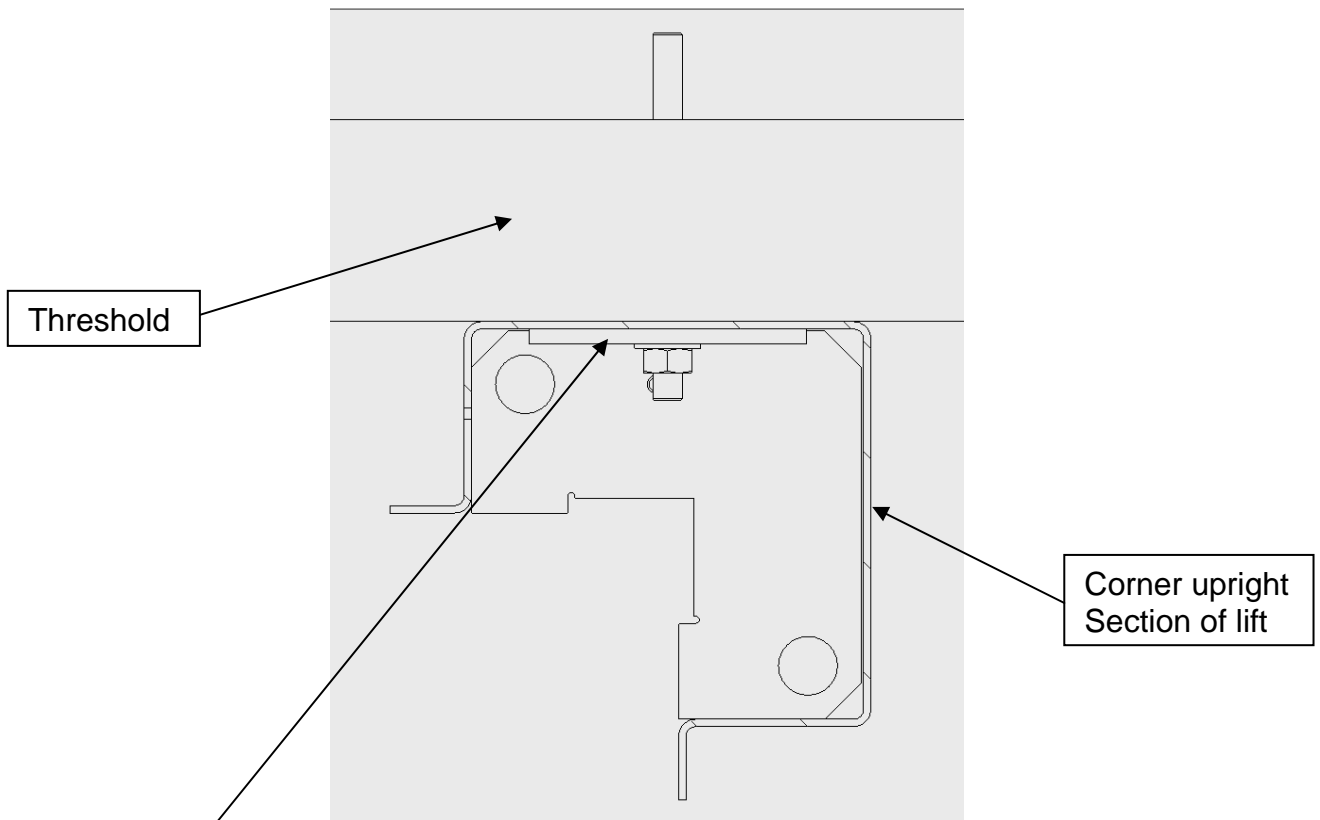

Fig. 1a Spreader plate position.

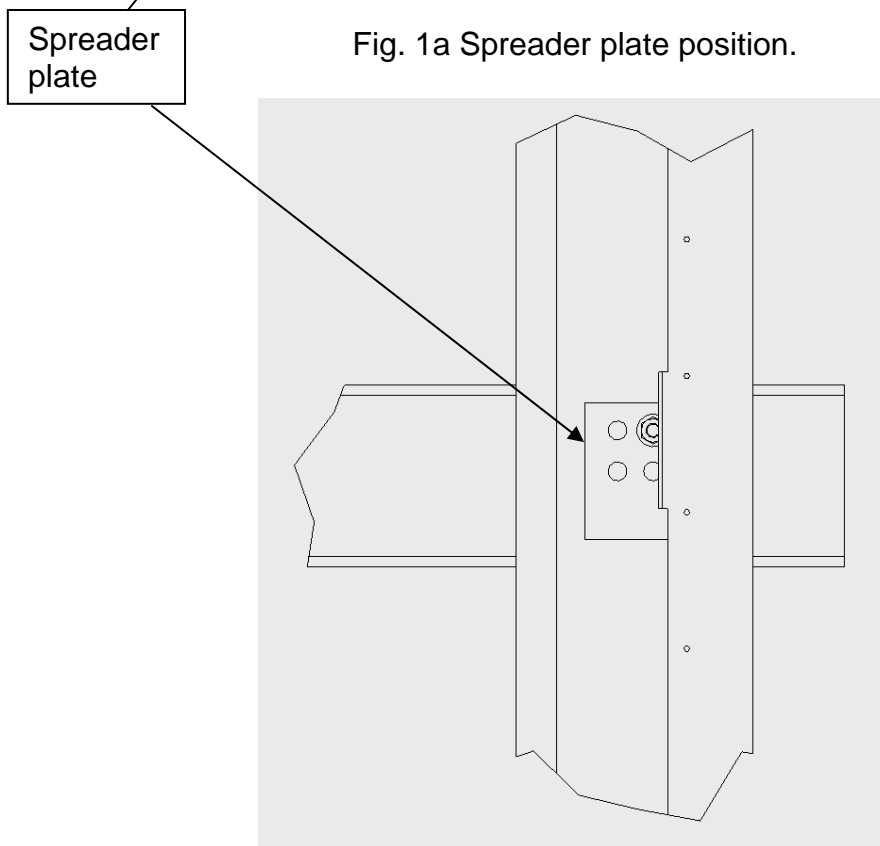

Fig. 1b Spreader plate position (2)