

TB 175

TECHNICAL BULLETIN

SAFETY ISSUE

For the Attention of: Service Engineers, Passenger Lift Installers, Platform Lift Installers, Trade Customers, Training Depts, H & S Managers.

Date: 17th October 2019

Product: FX Steel structure – used on Midilift Piccolo and Passenger Lift models

Subject: Integrity of 'T' clips to secure the steel ring assemblies on FX structures.

Pages: 3

Originator: Stannah Lifts Ltd, Anton Mill, Andover, Hants SP10 2NX 01264 339090

Background:

A near miss incident (ref 21770) has been reported on a recent Midilift Piccolo installation incorporating the FX steel structure. During the initial stage of installing the structure, one of the lower ring assemblies slipped downwards after being clamped in position using the 'T' clips. The ring assembly was boarded out and was being used by one of the installers as a working platform to build the steel structure as detailed in the

Installation Guide (See Figure 1).



Corner angular upright

Ring assembly - clamped to angular uprights by a total of 8 'T' clips (2 in each corner)

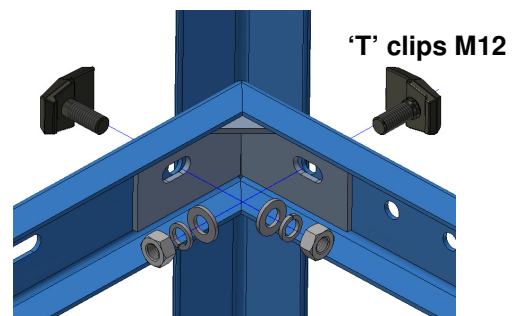

Ring corner joint assembly

Figure 1

Root cause:

Investigations have established that the root cause was due to some of the 'T' clips, which clamp the ring assembly to the corner angular uprights, not engaging correctly (See Fig 2).

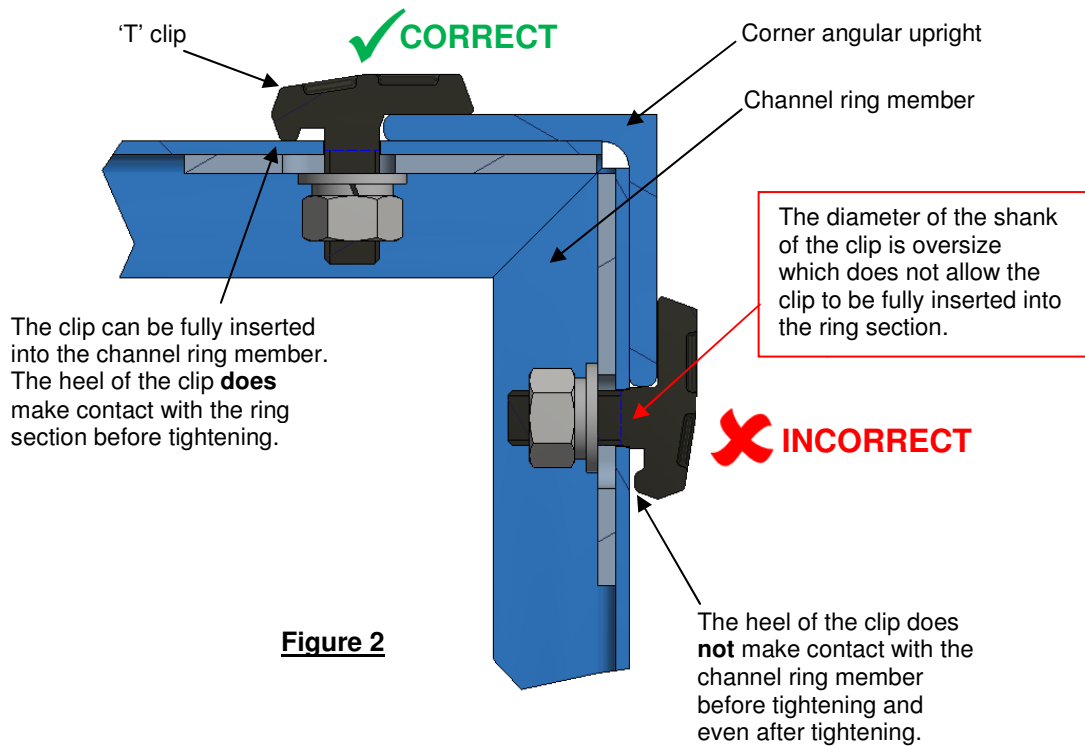

Figure 2



Figure 3

An inspection of the batch of 'T' clips at our works has confirmed an inconsistency of the shank diameter. This can result in some of the clips not being able to be fully inserted into the hole in the channel ring member and therefore not clamping with enough force when tightened to the recommended torque. The batch of clamps affected are stamped M2 as shown in Figure 3.

V

The guide clips are also used to fix the guide rails in place via steel brackets. The guide rails are of a thicker section than the corner uprights on the FX structure so they clamp the guide rails as intended, regardless of any inconsistency in the diameter of the shank on the clip.

Corrective actions:

All lifts in storage incorporating an FX structure will be inspected and clips stamped as shown in Figure 3 will be replaced with a correct alternative batch.

Installation Engineers: Particular care must be taken when assembling the ring corner joints on all FX structures, prior to using a boarded ring assembly as a working platform.

If any 'T' clips cannot be fully inserted as shown in Figure 2 then they should not be used to assemble the ring members and must be replaced with a clip that does. This is vital to ensure that the ring assembly cannot slip downwards when using it as a working platform.

Installation and Maintenance Engineers: Particular care should also be taken when dismantling an FX structure lift installation. It is important to reiterate the recommendations in the LEIA Safety Information Sheet ref. PA 69 regarding the Demolition and Dismantling of Lifts. This states that the risks involved in dismantling lifts must be carefully managed and must only be undertaken by a suitably qualified contractor and after a site-specific risk assessment.