

2. General Description

Highest Call Down Collective (HCDC) Suitable for residential flats and multi-storey car parks

This system has one 'up' button at the lowest floor and one 'down' button on all remaining floors.

Landing calls are registered. If the car is free or descending from the top floor, it will answer landing calls from the highest call, then other calls in succession, as it continues down approaching the main floor (usually ground).

Calls registered from the car will be retained at any time and answered in a logical sequences according to the direction of car travel.

Note. When a level exists below the main floor (usually ground), one 'up' button and one 'down' button is provided at the main floor level.

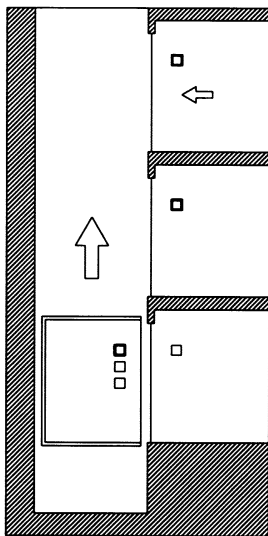

(A)

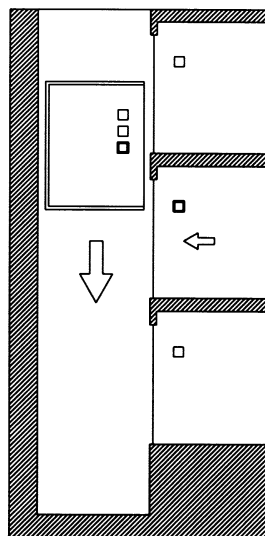

(B)

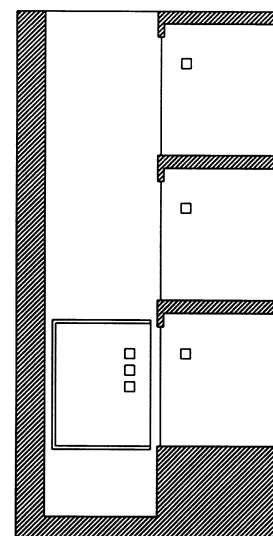

(C)

Highest Call Down Collective