

---

## 2. General Description

---

### Automatic Push Button (APB) Suitable for 2 floor lifts only.

This system has one button 'up' at the lowest floor, and one button 'down' at the highest floor.

Only one call at any time can be placed in the system (car or landing). This system will not register or hold another call until the call has been answered and doors have closed.

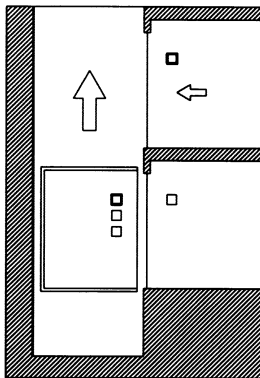

(A)

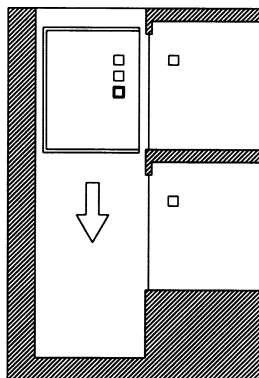

(B)

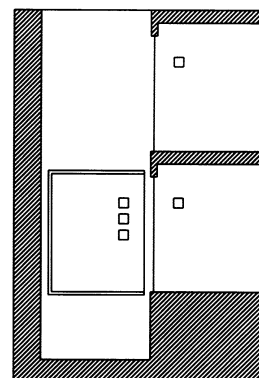

(C)

Automatic Push Button