

Waiver:

This data sheet is for guidance only and must not be used for proper working drawings. Please contact Stannah Lifts for particular details before proceeding. Owing to our policy of continual improvement we reserve the right to alter specifications and dimensions without prior notice.

For guidance only

THE STANNAH STAIRISER CR

Curved Rail
Wheelchair Platform Stairlift
Clearances

Stannah

Note: Diagram shows dims for free standing lift

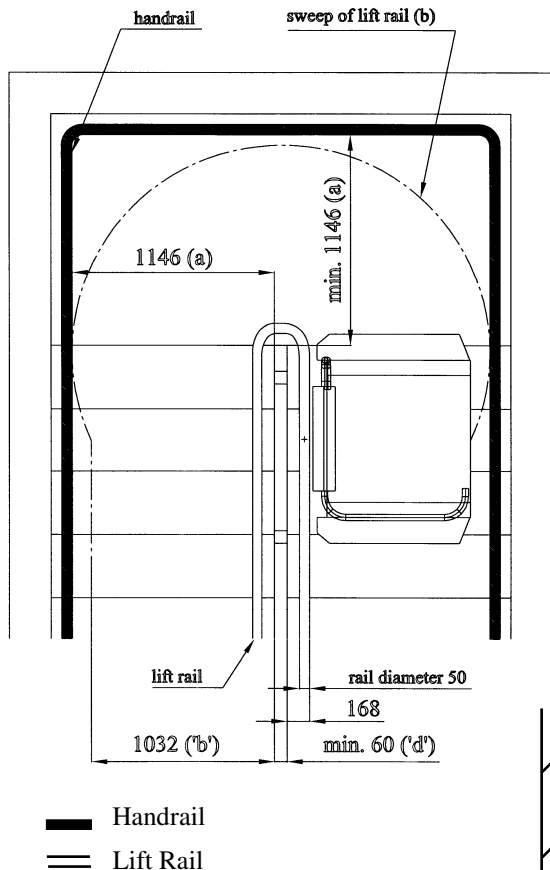

Notes

- ◆ The swing of the turning platform ('a') is 1146mm. This dimension allows for support post fixing, 200mm end ramps & 40mm running clearance.
- ◆ Dim 'a' is reduced by 62mm if the lift rail can be wall mounted. Thus clearance required becomes 1084mm.
- ◆ Dim 'a' is further reduced by approx. 20mm by specifying 150mm end ramps.
- ◆ Clearance required ('b') if lift does not turn is 1032mm (free standing) or 970mm (wall mounted). These measurements will apply for example, to applications using a straight rail with no bends.
- ◆ 150mm should be added to any clearance dimension 'a' & 'b' where a side load platform is specified.
- ◆ Clearance dims. 'a' & 'b' are measured from the stairs side (inside) of any handrail, string or skirting to opposing wall or obstruction e.g. outside handrail. Inside handrails are often removed for the lift installation, but refer to 'Building Regulations' comments below.
- ◆ Min. distance between well side of back to back strings / skirts etc is 60mm ('d').

Landing Arrangements

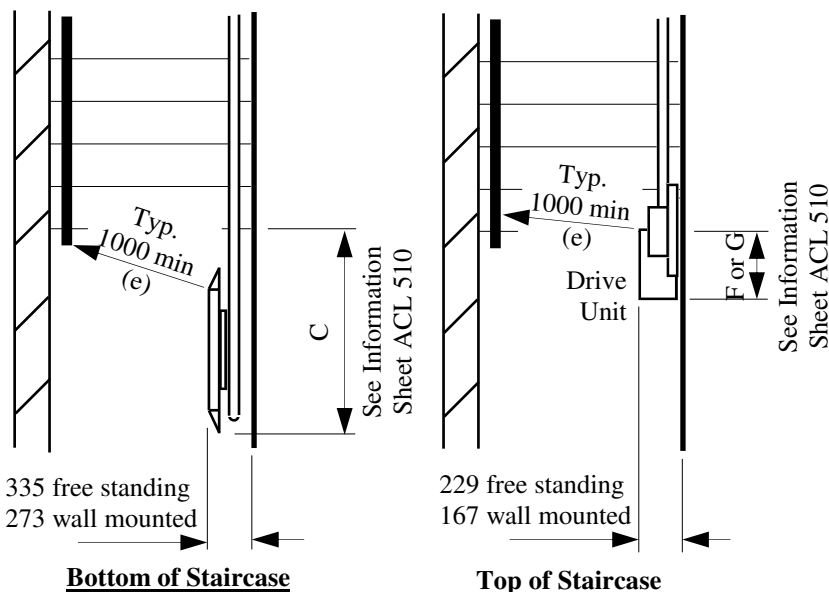

Building Regulations

- ◆ Building Regulations should always be considered when assessing the feasibility of a stairlift; Part M describes requirements to ensure adequate facility for disabled persons' access.
- ◆ Further parts of the Building Regulations or requirements from the Fire Officer may be applicable to the proposed installation. Clearances to the unfolded or folded platform or rail may need to be increased over those dictated for 'a' or 'b' e.g. dim e.
- ◆ The lift's upper rail is not intended to serve the purpose of a handrail - it's height will normally be above that specified in Building Regulations. Thus a separate handrail may need to be specified as builders work.
- ◆ Panelling of the spaces between lift support pillar upright may need to be carried out by builders after the lift is installed. This action will serve to satisfy Building Regulations requirement for a balustrade & also ensure no hazard is created as a result of lift movement.

- ◆ The drive unit is always located at the top landing. Dims & clearances for the simplest arrangement is shown (an alternative drive is available for heavy duty applications).
- ◆ A separate remotely mounted cabinet houses all necessary electrics (see Information Sheet ACL 514, *Drive Cabinet*).
- ◆ See Information Sheet ACL 512 for lower landing parking options. Rail can similarly be turned at top landing to permit particular clearance requirements.

INFORMATION SHEET
No. ACL 511
 09.08.18