



the

Stannah *advantage*



*Discover the
versatility
that makes
Stannah
Passenger Lifts
a British
winner*



Better by Design



the Stannah choice....



Designing and manufacturing our unique range of passenger lifts in the UK gives our customers the Stannah advantage ~

Choice...



- Traditional motor room

The Stannah MR

- Motor room cabinet

The Stannah MRC

- Motor room-less

The Stannah MRLi

- Low headroom

When compared to traction lift products

- Reduced pit depth

When compared to traction lift products

- Structure supported

Saving installation times and cost

- Our new lift car finishes

Light, stylish and versatile

- Be-spoke options

Ultimate choice

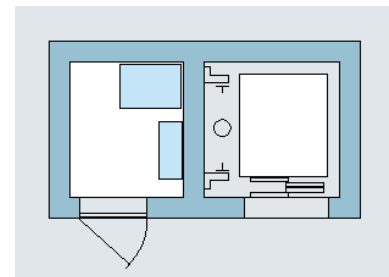
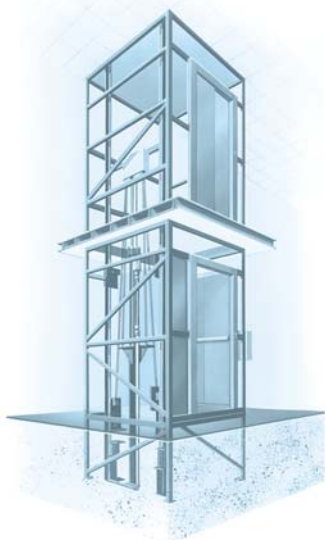

MR:

Standard Separate Motor Room
For those who prefer the traditional arrangement

The Stannah Match

We aim to match your specific requirements giving you a lift that suits your concepts, your building and your budget. That's why our range has grown with the addition of motor room-less lifts but traditional motor rooms remain - because our customers are not all the same.

The Stannah Service

Our reputation for exceptional customer service is deserved. We are happy to help you in any way that we can; liaising with professionals involved in every step of your project in order to give you the result you expect from Stannah.

The Stannah Finish

New lift car finishes across the whole passenger lift range give our customers the flexibility to match their lift to its surrounding environment. And, of course, every Stannah lift is manufactured to meet or exceed all the latest standards.

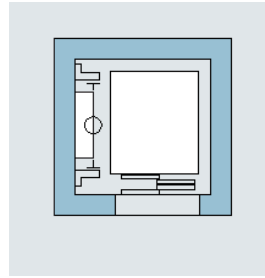
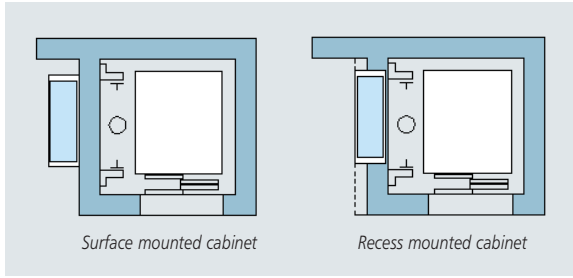

MRC:
Motor Room Cabinet
 Offers a smaller internal lift shaft and lower pit depth

MRLi:
Completely
Motor Room-less

The Stannah MR

MR simply means a separate motor room; for customers with large premises who prefer the traditional arrangement for the housing of the drive system.

The advantage; ultimate safety for an engineer.

The Stannah MRC

MRC means a lift with a motor room cabinet. The drive system and controller are housed in a cabinet that can be remotely located on an adjacent wall on any landing.

The advantage; a reduction on the lift shaft width, saving valuable space in smaller premises and safety for an engineer.

The Stannah MRLi

MRLi is simply a truly motor room-less lift. The drive system and controller are located within the pit and lift shaft, eliminating the need for a motor room.

The advantage; reduced building and operating costs combined with improved performance.

The Stannah FX - Structure Supported

FX simply means a Stannah lift supplied in its own structure to fit anywhere within a building. There is no need for a lifting beam - this is supplied on the structure which is assembled within the shaft. The FX can be installed into existing lift wells too.

A structure supported lift is particularly useful in timber framed buildings where the walls may be unable to support a traditional shaft.

The advantage; reduction of building works required prior to installation, saving time and money with the additional benefit of ultimate flexibility in the location of the lift.

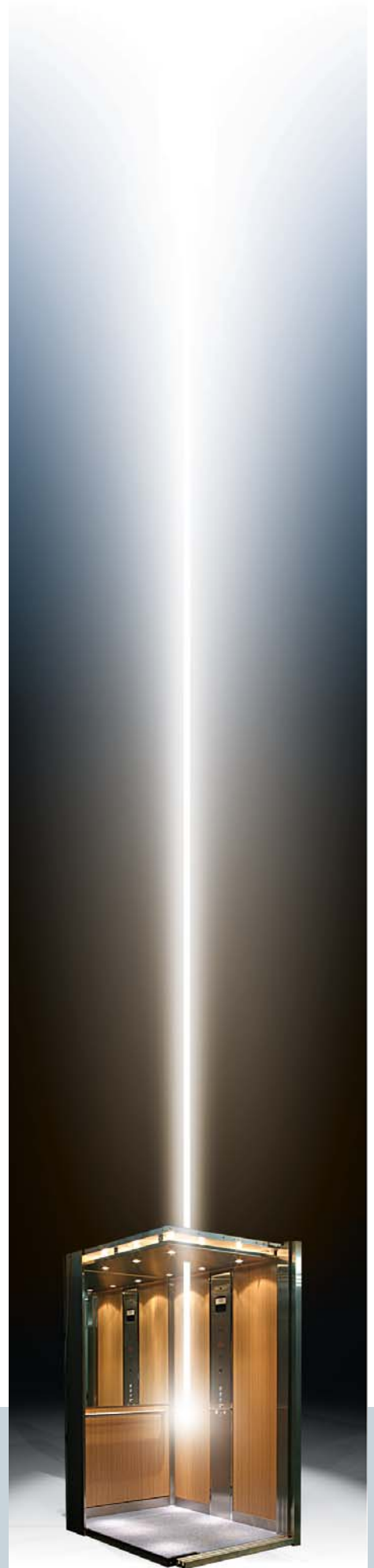

Hydraulics ...the safer choice



In these days of heightened Health & Safety awareness we should all be doing everything possible to reduce or eliminate risks to ourselves and to those around us. Indeed we have a legal obligation to do so.

At Stannah we are convinced that, for low to medium rise applications, a 'hydraulic' passenger lift is inherently safer than a 'traction' alternative and more convenient.

EMERGENCY RELEASE

A 'hydraulic' lift offers easy emergency lowering and is safe and convenient for the owner and the lift engineers. You simply push a button and the lift will automatically lower.

SAFETY FOR THE SERVICE ENGINEER

No special working platforms are required to maintain the drive system. Most service work can be carried out in complete safety.

REDUCED MAINTENANCE COSTS

As there are less pulleys and shorter lengths of wire ropes in hydraulic lifts there is less wear and tear compared to most traction units. Therefore hydraulic life-time costs should be considerably lower and the components will last longer.

ENERGY SAVING

It is important to remember a hydraulic lift uses power only in the 'up' direction. It uses gravity to travel downwards, with a small amount of energy operating the valves. It is a simple, efficient and highly effective piece of engineering.

ENVIRONMENTALLY FRIENDLY

Hydraulic oil has an enormous life span and may well last the life of the lift. If it ever needs replacing, it is recycled or used to power electricity generation.

REDUCED BUILDING COSTS

There is no excessive loading on the hydraulic lift shaft and they require less lifting beams than traction options, so save energy, time and money.



Stannah Lifts Ltd

Anton Mill, Andover, Hampshire SP10 2NX

Fax: 01264 337942

Telephone: 01264 339090

Web: www.stannahpassengerlifts.co.uk

Email: passengerliftsales@stannah.co.uk

Due to Stannah's policy of continuous improvement and development, we reserve the right to alter specifications and dimensions without prior notice.